

DRAWN BY: BILL BERENS

DECELERATION LENGTH = D (MIN.)						
POSTED SPEED (MPH)	WORK ZONE POSTED SPEED LIMIT (MPH)					
	10	20	30	40	50	60
70	525	500	425	350	250	150
65	425	400	350	275	175	
60	350	300	250	175		
55	275	225	175	100		
50	200	150	100			
45	125					

SIGN SPACING = X (1)		
RURAL HIGHWAYS	60 / 65 MPH	800' ±
RURAL ROADS	45 / 55 MPH	500' ±
RURAL ROADS & URBAN ARTERIALS	35 / 40 MPH	350' ±
RURAL ROADS, URBAN ARTERIALS, RESIDENTIAL & BUSINESS DISTRICTS	25 / 30 MPH	200' ± (2)
URBAN STREETS	25 MPH OR LESS	100' ± (2)
ALL SIGNS ARE BLACK ON ORANGE UNLESS DESIGNATED OTHERWISE		

- (1) ALL SIGN SPACING MAY BE ADJUSTED TO ACCOMMODATE AT-GRADE INTERSECTIONS AND DRIVEWAYS.
- (2) THIS SIGN SPACING MAY BE REDUCED IN URBAN AREAS TO FIT ROADWAY CONDITIONS.

**NOTES**

1. Install additional Warning Signs based on site conditions and traffic characteristics. See an appropriate Standard Plan for guidance.
2. Regulatory Speed Limit signs are not a substitute for Work Zone Warning signs. Speed Limit signs shall remain in place as long as the reduced speed condition applies.
3. Motorcycle Warning Signs are required as per Washington Administrative Code (WAC) 468-95-305.
4. Closing a road and restricting traffic shall conform to Revised Code of Washington (RCW) 47.48.
5. For signs size refer to Manual on Uniform Traffic Control Devices (MUTCD) and WSDOT Sign Fabrication Manual M55-05.

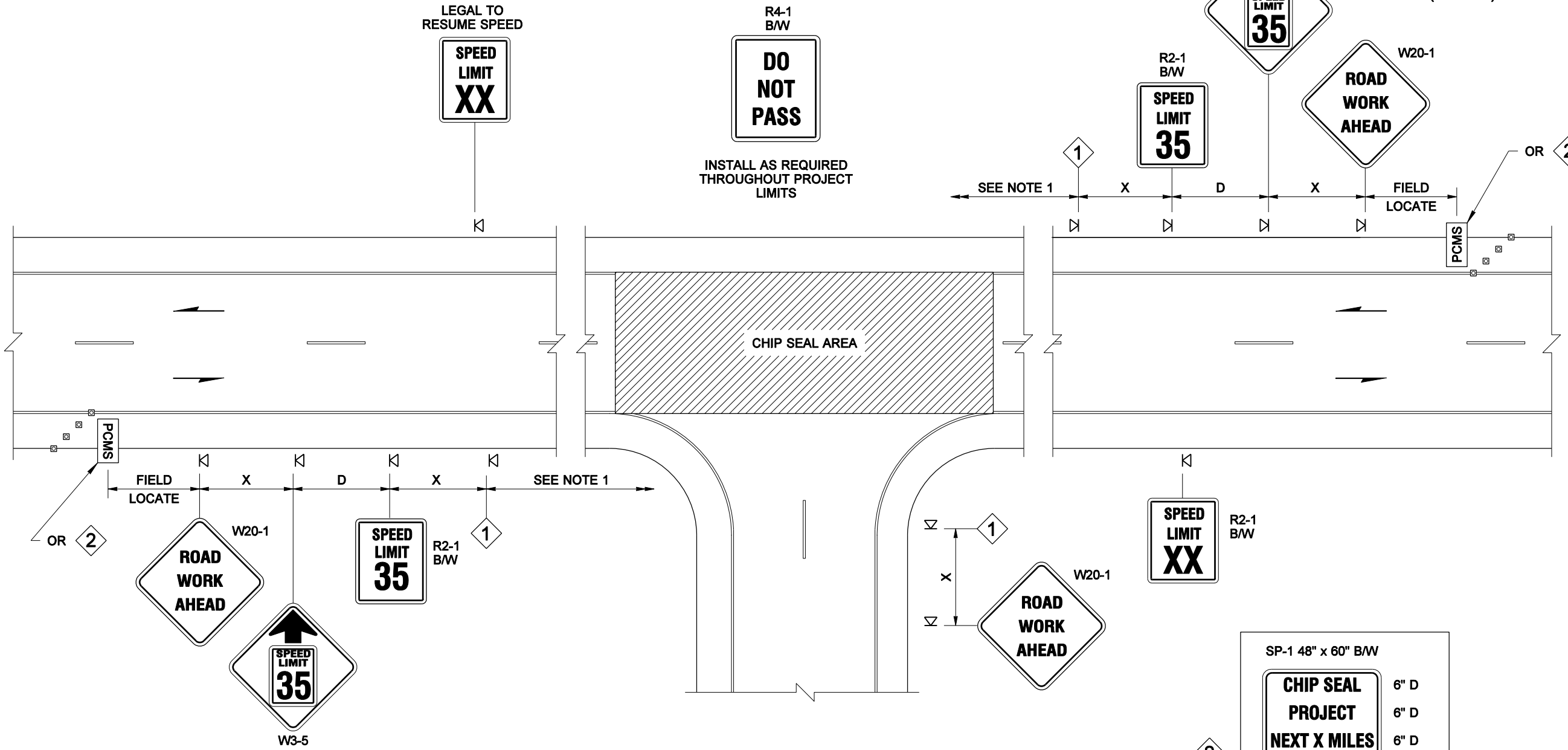

PCMS SAMPLE MESSAGE	
1	2
CHIP SEAL PROJECT	FROM AUG XX TO AUG XX
1.5 SEC	1.5 SEC

FIELD LOCATE IN ADVANCE OF SIGNING

**FOR LOCAL AGENCY USE ONLY  
NOT FOR USE ON STATE ROUTES**

**LEGEND**

- SIGN LOCATION
- CHANNELIZING DEVICES
- PORTABLE CHANGEABLE MESSAGE SIGN

1

6" E  
6" E  
14" E

**LOOSE GRAVEL 35**

SP-2  
36" x 48"  
B/O

**MOTORCYCLES USE EXTREME CAUTION**

W21-1701  
OR OTHER APPROPRIATE WARNING SIGN DEPENDING ON SITE CONDITIONS

2

SP-1 48" x 60" B/W

**CHIP SEAL PROJECT NEXT X MILES AUG XX TO AUG XX**

6" D  
6" D  
6" D  
6" D

FIELD LOCATE IN ADVANCE OF SIGNING  
TYPICAL SIGN INSTALLATION (CHANNELIZING DEVICES NOT REQUIRED)



EXPIRES AUGUST 9, 2009

**SPEED ZONE SUPPLEMENTAL SIGNING ~ CHIP SEAL PROJECT STANDARD PLAN K-60.20-02**

SHEET 1 OF 1 SHEET

APPROVED FOR PUBLICATION

**Pasco Bakotich III** 07-03-08  
STATE DESIGN ENGINEER DATE

Washington State Department of Transportation

NOTE: THIS PLAN IS NOT A LEGAL ENGINEERING DOCUMENT UNLESS IT IS APPROVED AND SEALED BY THE ENGINEER AND APPROVED FOR CONTRACT BY THE FILE AT THE WASHINGTON STATE DEPARTMENT OF TRANSPORTATION. A COPY MAY BE OBTAINED UPON REQUEST.